

How to fit your Wall Mounted Headboard

We have sent you

- Your headboard
- Wooden batten

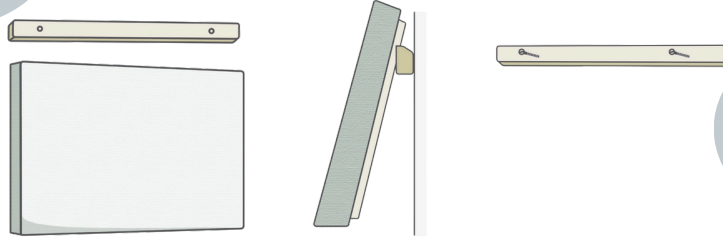

Sewing House

You will need

- Drill with the correct bit
- Metal tape measure
- Crossheaded screw driver
- Pencil

How to fit a headboard to the wall

Our headboards come with one half of the split batten fixed to the headboard.

Step 1

Decide on the bed position and check for any obstructions such as cables or pipes in the wall and plan accordingly.

Step 2

Measure the height of your bed, including the mattress.

Step 3

Add to this either 48cm (19") (for our 70cm headboard) or 78cm (31") (for our 100cm headboard). This is your batten height measurement.

Step 4

Mark this height measurement from the floor at two or more points on the wall behind the bed position - this is the height to the bottom of the wall fixed batten.

Step 5

Align the bottom of the wall fixed batten to the marks, with the angle pointing up away from the wall, align horizontally with the bed position. Check that the batten is level and mark the screw positions.

Step 6

Drill and plug the wall at the screw positions. Screw the batten to the wall and hang the headboard.

Top Tip: For dry lined or stud walls, ensure that the plugs are a snug fit in the drilled holes. Use specialist plasterboard fixings for stronger fixings as necessary.